



Up to 5 t in a single strand

**3**  
YEARS  
warranty

PREMIUM  
PRO 3,2



## LEVER HOIST | PREMIUM PRO

The next development stage of the reliable PREMIUM lever hoist is the PREMIUM PRO. Thanks to a significant weight saving, handling is improved. Despite this, the frame has been strengthened compared to the previous generation. Proven quality also ensures longevity and its design makes it very robust.

### Free-running mode

When the selection switch is moved to the middle point, the unladen chain can easily be pulled through the device freely to the required usage length. This makes tensioning the chain easier.

### Load chain

The tempered, galvanised load chain according to DIN EN 818-7-T is supplied with the unit. The standard lifting height is 1.5 m; any length required for higher lifting is possible.

### New chain end piece

The robust chain end piece provides additional safety because it cannot be pulled through the device with the chain.

### Protected handle

The ergonomic rubber handle on the end of the lever protects the user against injury and is also screwed in place to prevent it slipping.

### Technical advantages

Hand lever can be used in any position thanks to the ratchet; safety automatic mechanical brake; galvanised connecting parts; cast hook clip; large, non-slip and closed hand wheel; safety chain end piece, approved for load securing according to EN 12195-3.

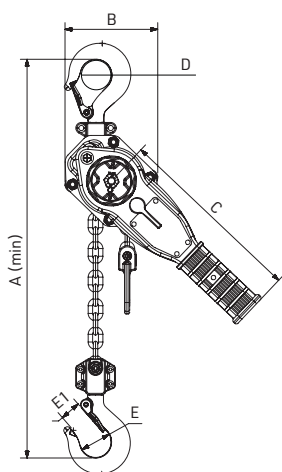

PREMIUM PRO 800 – 3,200 kg

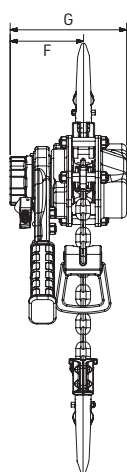

PREMIUM PRO 6,400 kg

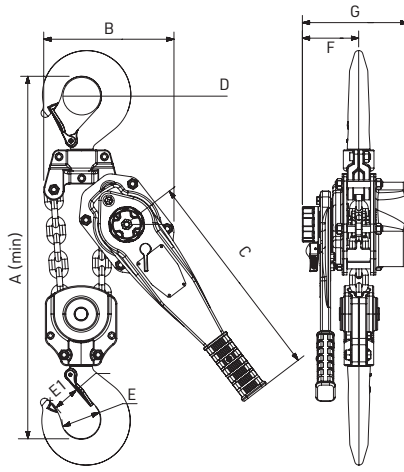

PREMIUM PRO 9,600 kg

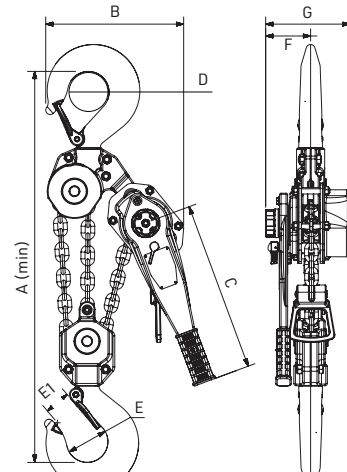

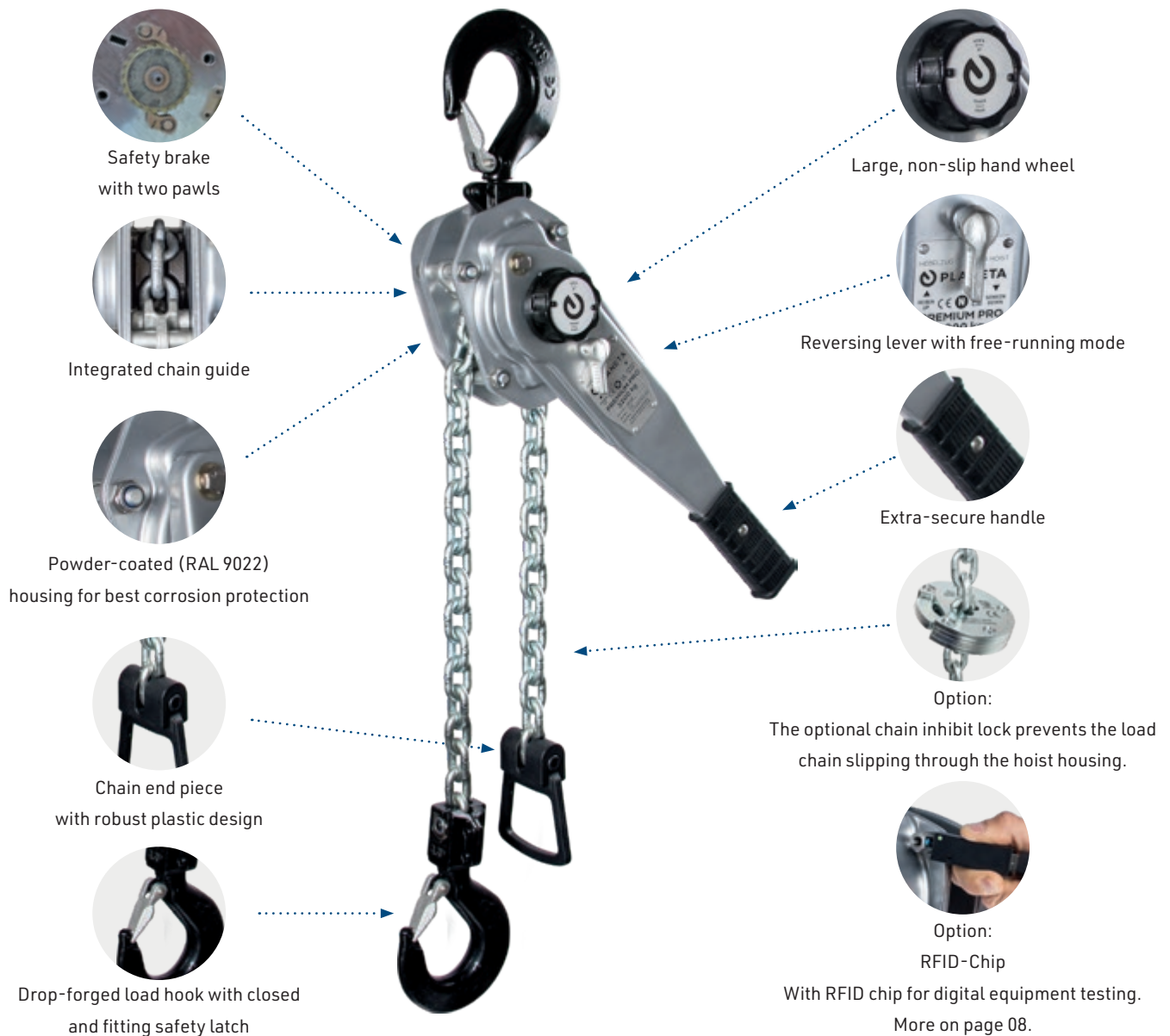

TYPE	PREMIUM PRO ...	0.8	1.6	3.2	5	6.4	9.6
Capacity	kg	800	1,600	3,200	5,000	6,400	9,600
Standard lift	m	1.5	1.5	1.5	1.5	1.5	1.5
Min. headroom (A)	mm	320	360	431	655	500	635
Lever force at 100 % load	daN	22	24	33	37	36	38
Meters load chain movement with 1 round 360°	m	0.019	0.015	0.016	0.009	0.008	0.005
Number of chain falls		1	1	1	1	2	3
Chain size	mm	6 × 18	7.1 × 21	9 × 27*	13 × 36	9 × 27*	9 × 27*
B (Dimensions)	mm	115	137	169	180	238	300
C	mm	239	259	374	400	374	374
D	mm	35	42	48	60	60	70
E	mm	35	38	46	43	59	54
E1	mm	23	28.5	33	41	39	51
F	mm	91	67	98	104	98	98
G	mm	146	162	187	213	187	187
Weight with standard lift	kg	6.3	8.8	16.4	32.5	24.9	42.1
Weight for 1 m additional lifting height	kg	0.7	1.1	1.8	3.7	3.6	5.4
PREMIUM PRO ... with 1.5 m lift	Order No.	G10390	G10391	G10392	G10280	G10394	G10395
PREMIUM PRO ... with 3 m lift	Order No.	G10390-3	G10391-3	G10392-3	G10280-3	G10394-3	G10395-3
PREMIUM PRO ... with 6 m lift	Order No.	G10390-6	G10391-6	G10392-6	G10280-6	G10394-6	G10395-6
Additional 1 m lift	Order No.	G10086	G10087	G10249	G10287	G10254	G10256
Chain lock	Order No.	G10450	G10451	G10452	G10453	G10452	G10452
RFID-Chip incl. mounting	Order No.	G10600	G10600	G10600	G10600	G10600	G10600

\* Grade 100