

Ersatzteile

Spare parts

Pièces de rechange

Onderdelen

Reservedele

Varaosat

Pezzi di ricambio

Reservedeler

Peças

Reservdelar

Piezas de recambio

EM - NL 1Ph



EM 50 NL 1Ph

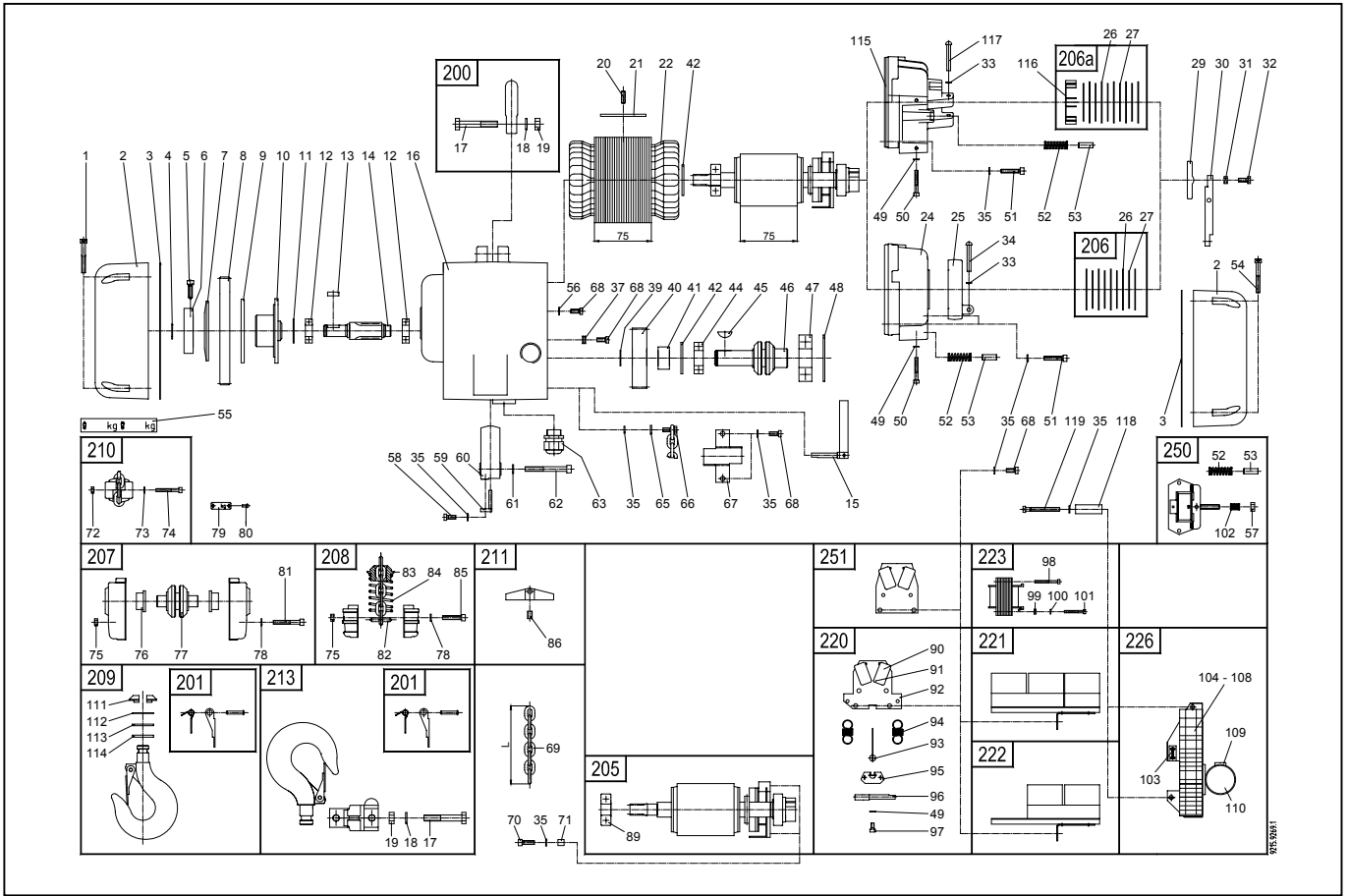

EM 50 NL		
1	M5 x 40 VZ	9030.0268
2	252 x 182 x 70	9215.3001.1
3	252 x 182 x 6	9215.3003.3
4	15 x 1	0031.1009
5	M5 x 20	9210.3057.4
6	Rd 60 x 12	9210.3048.4
7	Rd 80/42 x 3	9210.3047.4
8	Rd 144 / z=138	9210.3010.4
9	Rd 85/7.5 x 4	9210.3020.4
10	Rd 86 x 34.5	9210.3013.4
11	32 x 1.2	0031.1115
12	6002	0038.1033
13	5 x 5 x 15	9038.0001
14	Rd 28 x 88.5	9210.3031.4
15		9210.3037.4
16	252 x 182 x 137	9215.3000.0
17	M8 x 50/22 VZ	9030.5307
18	M8 VZ	9031.3904
19	M8 VZ	0031.0008
20	M5 x 16	0030.2112
21	Rd 3 x 60	9031.5853
22	L=75 1Ph 110/220V 50Hz -NL	9212.0070.4
	L=75 1Ph 115/230V 60Hz -NL	9212.0071.4
24		9215.3002.2
25		9215.3004.3
26	Rd 51/33 x 1	9210.3507.4
27	Rd 50/33 x 1	9210.3508.4
29	Rd 50 x 8.5	9210.3015.4
30	FL 15/10 x 94	9215.3015.4
31	M5 VZ	0031.0036
32	M5 x 12 VZ	9030.5251
33	Gr. 5	9031.1151
34	ø5 x 35 mm	9031.7003
35	M5 VZ	9031.3902
37	M5	9058.5001
39	20 x 1.2	0031.1013
40	Rd 80.4 x 19	9210.3033.4
41	Rd 30/20.5 x 18	9210.3034.4
42	42 x 2.5	9035.0014
44	6004-LLUA	9038.0002
45	6 x 7.5 x 18.6	9036.0600
46	L=96	9211.3032.2
47	6305-2Z	0038.1197
48	62 x 2	0031.1127
49	M4 VZ	9031.3901
50	M4 x 30 VZ	9030.0257
51	M5 x 25 VZ	9030.0265
52	8.5/1.5 x 30	9210.3065.4
53	Rd 6.8 x 21	9210.3345.4
54	M5 x 35 VZ	9030.3254
55	0.5/1.0 t	9216.3043.4
56	5.3/10 x 1 MS	0031.0616
57	M6	9031.1276

EM 50 NL		
58	M5 x 12 DIN 6912	9030.0003
59		9211.3014.4
60		9216.3006.3
61	M6 VZ	9031.3903
62	M6 x 55/24 VZ	9030.0305
63	PG 11	9055.3006
65	M6 VZ	9031.3903
66	ø6 M5 x 16	0030.4083
67	70 x 50 x 11.5	9215.3153.4
68	M5 x 12 VZ	0030.3468
69	5 x 15	0039.0005
70	M5 x 16 VZ	9030.0262
71	8/1.4 x 7	9215.3014.4
72	M5 VZ	0031.0036
73	M5 VZ	9031.3902
74	M5 x 30/22 VZ	9030.0266
75	M6 VZ	0031.0037
76	20 E7/28 x 16	9038.1255
77	Rd 48 x 60	9211.3045.4
78	M6 VZ	9031.3903
79	500 kg	9211.3340.4
	1.0 t	9216.3041.4
80	3 x 5	9031.6604
81	M6 x 35/24 VZ	9030.0278
82	6 x 30	9216.3033.4
83	Rd 36 x 19	9216.3035.4
84	Nr. 121	9034.1007
85	M6 x 35 VZ	9030.0278
86	M6 x 10 SW	0030.2322
89	6302-LLUA	9038.0003
90	XG3	9051.0500
91	M3 x 14 VZ	9030.3251
92	80 x 3 x 66	9210.3105.4
93	12 x 60	9210.3100.4
94		9210.3107.4
95	15 x 15 x 30	9210.3108.4
96	Rd 10 x 53	9210.3099.4
97	M4 x 8 SW	9030.0001
98	M3 x 30 VZ	0030.3439
99	M3 VZ	0031.0034
100	M3 VZ	9031.3900
101	M3 x 25 VZ	0030.3438
102	8/0.75 x 12	9210.3067.4
103	1.6 A	9052.0010
104	2-F	9058.0018
105	4-F	9058.0017
106		9058.0019
107		9058.0020
108		9058.0024
109	30 - 40 mm	9058.4008
110	ø38 x 45, 240 µF	9059.0001
	ø45 x 124, 40 µF	9059.0008
111		9216.3134.4

EM 50 NL		
112		0038.3133
113		9038.0250
114		9038.1755
115	1Ph	9215.3150.2
116		9215.3149
117	ø5 x 50 mm	9031.7009
118	ø8/5.2 x 30	9038.2255
119	M5 x 40 VZ	0030.3474
200		9215.3038.4
201		9210.3736.4
205	L=75 -NL 1Ph 50Hz	9216.3054.3
	L=75 -NL 1Ph 60Hz	9216.3068.3
206		9211.3345.4
206a		9216.3078.4
207		9216.3130.3
208		9216.3137.4
209		9216.3132.4
210		9216.3021.3
211		9210.3738.4
213		9216.3129.4
220		9211.3141.4
221	1Ph NA 42V	9212.2322.3
222	1Ph 42V	9212.2302.3
223	110/220/42V 50/60Hz	9056.4506.4
226	-NL 1Ph	9212.2054.3
250	110/220V 50/60Hz	9056.2504.4
251	Standard	9210.3667.4

EM 100 NL 1Ph

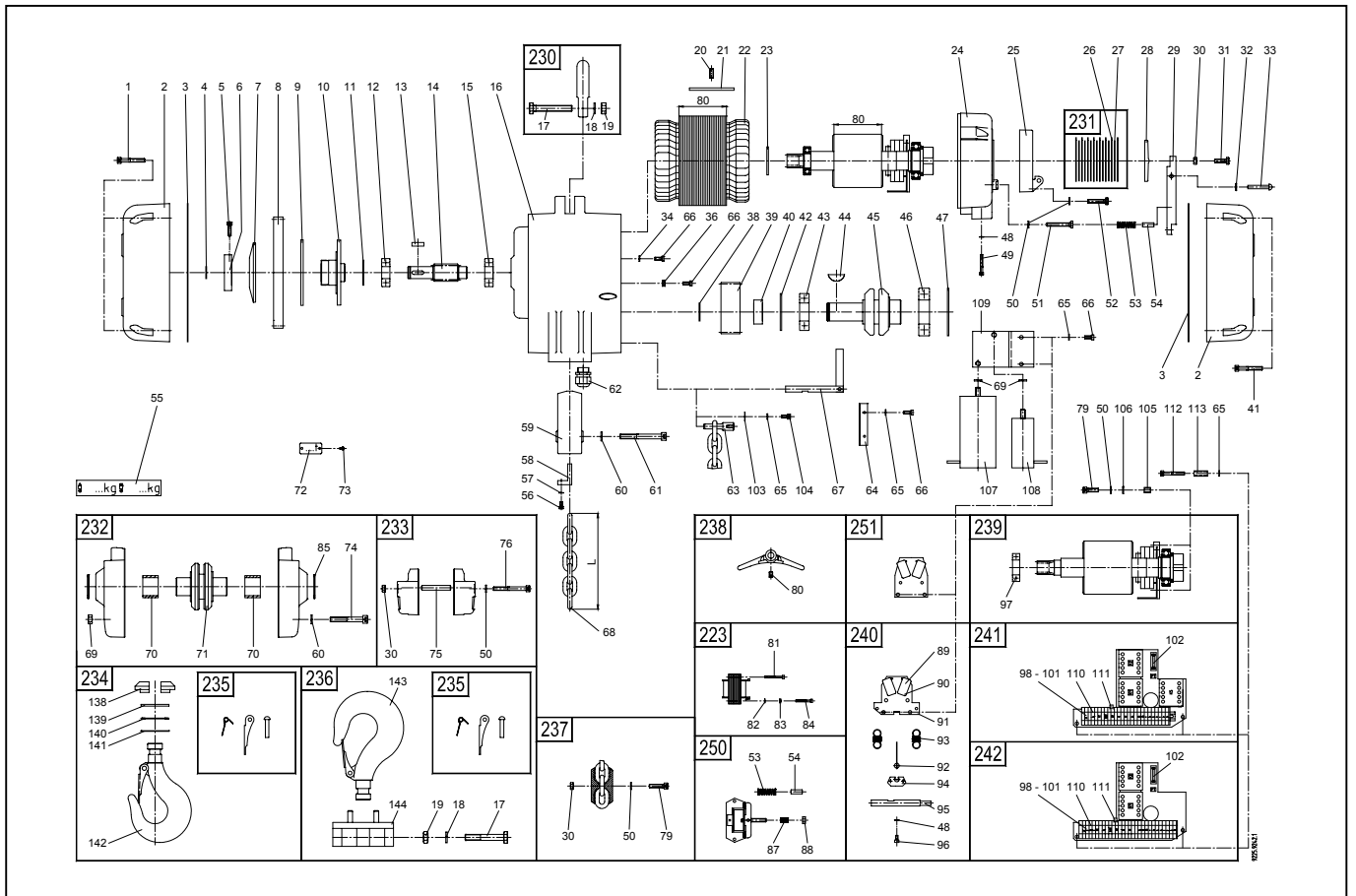

EM 100 NL		
1	M6 x 40 VZ	9030.0279
2	322 x 232 x 78	9225.3001.1
3	321 x 231 x 5	9225.3003.2
4	20 x 1.2	0031.1013
5	M5 x 20	9210.3057.4
6	Rd 60 x 12	9210.3048.4
7	Rd 100/42 x 4	9221.3178.4
8	Rd 200 x 16	9225.3011.3
9	Rd 110 x 4	9210.3153.4
10	Rd 109 x 40	9221.3104.4
11	42 x 1.75	0031.1120
12	6204	0038.1126
13	6 x 6 x 20	0038.0023
14	Rd 30 x 99.5	9225.3016.4
15	7204 B	9038.0004
16	322 x 275 x 156	9225.3000.0
17	M10 x 65 VZ	9030.5308
18	M10 VZ	9031.3801
19	M10 VZ	0031.0009
20	M6 x 14	9030.2501
21	Rd 4 x 7.5	9230.3097.4
22	L=80 1Ph 110/220V 50Hz -NL	9222.0070.4
	L=80 1Ph 115/230V 60Hz -NL	9222.0071.4
23	47 x 2.5	9035.0015
24	1Ph	9225.3100.2
25		9225.3004.3
26	Rd 78/50 x 1	9221.3299.4
27	Rd 67/40 x 1	9221.3300.4
28	Rd 69 x 7.5	9221.3111.4
29	Rd 15 x 15 x 131	9225.3015.4
30	M6 VZ	0031.0037
31	M6 x 20 VZ	9030.5263
32	Gr. 6	9031.1152
33	6 x 36	9031.7006
34	5.3/10 x 1 MS	0031.0616
36	M5	9058.5001
38	30 x 1.5	0031.1018
39	Rd 98.8 x 32	9225.3017.4
40	Rd 40/5 x 14.5	9221.3152.4
41	M6 x 40 VZ	0030.3492
42	62 x 2.5	9035.0016
43	6206 2RS	0038.1149
44	8 x 11 x 27.35	9036.0602
45	Rd 78 x 124.5	9220.3150.2
46	6208 2Z	0038.1130
47	80 x 2.5	0031.1132
48	M4 VZ	9031.3901
49	M4 x 30 VZ	9030.0257
50	M6 VZ	9031.3903
51	M6 x 40 VZ	9030.0279
52	M6 x 30 VZ	9030.0277
53	8.5/1.5 x 30	9210.3065.4
54	Rd 6.8 x 21	9210.3345.4

EM 100 NL		
55	500/1000 kg	9220.3257.4
56	M4 x 8 SW	9030.0001
57	M4 VZ	9031.3901
58	35/23.5/7 x 40	9221.3112.4
59	130 x 105 x 45	9225.3006.3
60	M8 VZ	9031.3904
61	M8 x 70 VZ	9030.0294
62	PG 11	9055.3006
63	Rd 13 x 50	9225.3098.4
64	18/14 x 1.5 x 70	9215.3007.4
65	M5 VZ	9031.3902
66	M5 x 12 VZ	0030.3468
67	97 x 10	9221.3154.4
68	7 x 22 mm, 8 m	9039.0007
69	M8 VZ	0031.0008
70	30/37 x 26	0038.3261
71	Rd 65 x 85.6	9225.3041.4
72	0.5 t	9220.3471.4
73	1 t	9220.3474.4
74	3 x 5	9031.6604
75	M8 x 55 VZ	9030.0307
76	Rd 8 x 49	9220.3166.4
77	M6 x 55 VZ	9030.0305
78	24/6 x 16	9225.3013.4
79	M10 x 75	9030.5290
80	M6 x 25 VZ	9030.0276
81	6 x 10 SW	0030.2322
82	M3 x 30 VZ	0030.3439
83	M3 VZ	0031.0034
84	M3 VZ	9031.3900
85	M3 x 25 VZ	0030.3438
87	I 37 x 1.5	0031.1117
88	8/0.75 x 12	9210.3067.4
89	M6 VZ	9031.1276
90	XG3	9051.0500
91	M3 x 14 VZ	9030.3251
92	80 x 3 x 66	9210.3105.4
93	12 x 60	9210.3100.4
94	15 x 15 x 30	9210.3108.4
95	Rd 10 x 100	9221.3197.4
96	M4 x 8 SW	9030.0001
97	6005 LLUA	9038.0005
98	2-F	9058.0018
99	4-F	9058.0017
100		9058.0019
101		9058.0020
102	1.6 A	9052.0010
103	5.3 x 15 x 0.8 VZ	0031.9311
104	M5 x 10 VZ	0030.9229
105	e9/6.2 x 10.5	9225.3089.4
106	e6.4/12.5 x 1.6	0031.0577
107	ø60 x 120, 120 µF	9059.0010

EM 100 NL		
108	ø37 x 83, 320 µF	9059.0011
109	70/65/42 x 60	9225.3082.4
110		9058.0024
111		9058.0022
112	M5 x 35 VZ	9030.0267
113	ø9 x 22.5	9211.2023.4
138	ø47 x 18	9225.3096.4
139	ø30/47 x 3	9038.1750
140	ø30/47 x 2	9038.0252
141	ø30/47 x 1	0038.3128
142		9225.3095.3
143		9225.3095.3
144	40/25 x 102	9226.3093.3
223	110/220/42V 50/60Hz	9056.4506.4
230		9225.3012.4
231	8 x A / 7 x l	9220.3480.4
232		9225.3020.2
233		9225.3019.2
234		9225.3094.4
235		9220.3482.4
236		9225.3103.3
237		9225.3021.3
238		9220.3481.4
239	L=80 -NL 1Ph 50Hz	9225.3079.3
	L=80 -NL 1Ph 60Hz	9225.3101.3
240		9221.3212.4
241	1Ph NA 42V	9222.2050.2
242	1Ph 42V	9222.2051.2
250	110/220V 50/60Hz	9056.2504.4
251	Standard	9210.3667.4

EM 200 NL 1Ph / EM 500 NL 1Ph

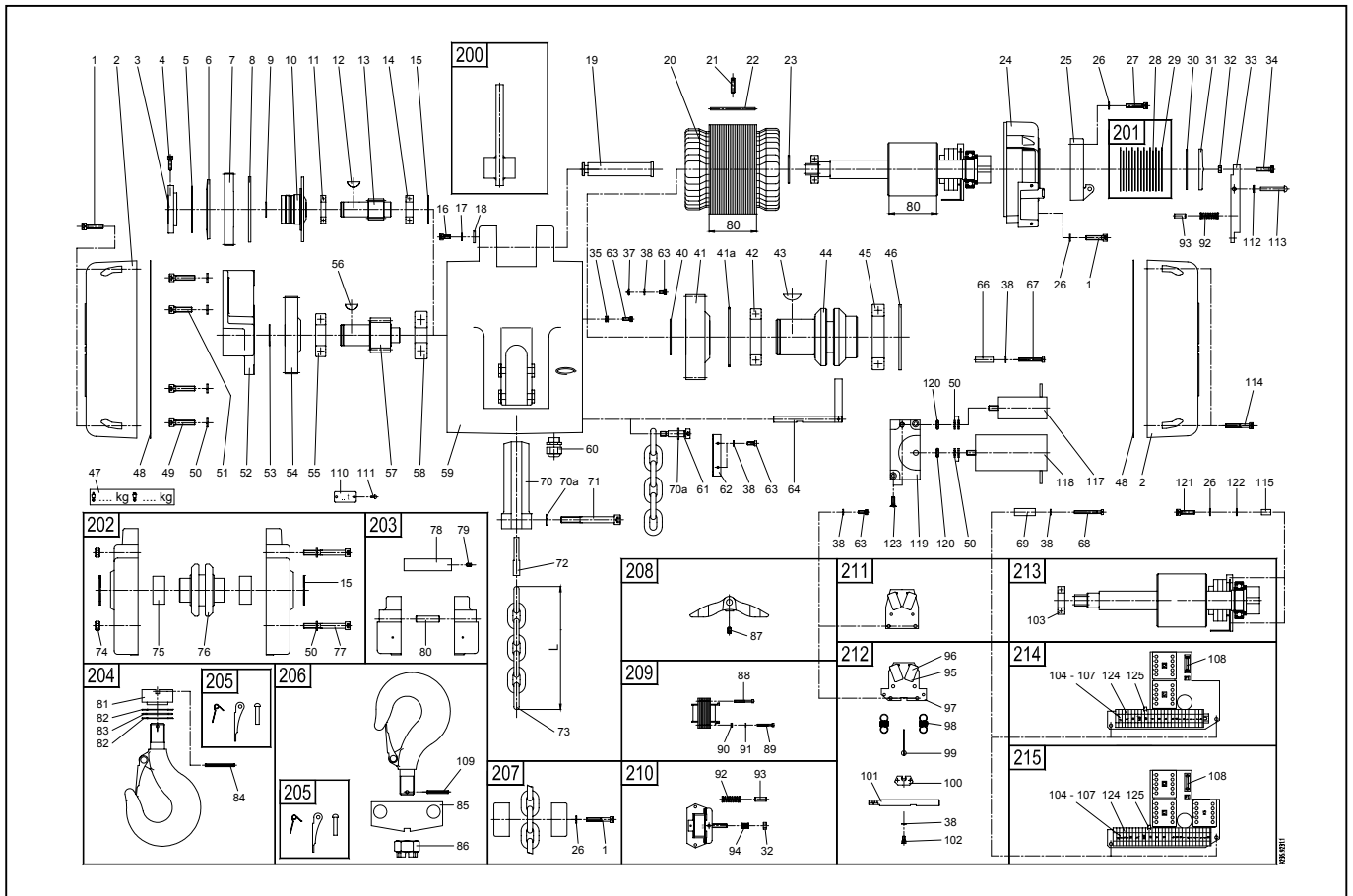

		EM 200 NL	EM 500 NL
1	M6 x 40/24 VZ	9030.0279	9030.0279
2	332 x 240 x 95	9235.3001.1	9235.3001.1
3	M48 x 1	9230.3056.4	9230.3056.4
4	M5 x 20 VZ	9210.3057.4	9210.3057.4
5	AS 5578	0038.3137	0038.3137
6	ø100/55 x 4	9230.3080.4	9230.3080.4
7	121.677 x 15	9235.3011.4	9235.3011.4
8	ø110/70 x 4	9210.3153.4	9210.3153.4
9	A 25 x 1.2	0031.1016	0031.1016
10	Rd 109 x 42	9230.3006.4	9230.3006.4
11	16 005	0038.1248	0038.1248
12	6 x 7.5 x 18.75	9036.0600	9036.0600
13	Rd 35.6 x 85	9230.3054.4	9235.3059.4
14	6005	0038.1036	0038.1036
15	I 47 x 1.75	0031.1122	0031.1122
16	M6 x 12 VZ	9030.0274	9030.0274
17	M6 VZ	9031.3903	9031.3903
18	20/3 x 110	9230.3076.4	9230.3076.4
19	ø22 x 120	9230.3075.4	9230.3075.4
20	L=80 110/220V 50Hz	9222.0070.4	9222.0070.4
	L=80 115/230V 60Hz	9222.0071.4	9222.0071.4
21	M6 x 25	0030.2124	0030.2124
22	ø4 x 75	9230.3097.4	9230.3097.4
23	ø47 x 2.5	9035.0015	9035.0015
24	1Ph	9235.3101.2	9235.3101.2
25		9225.3004.3	9225.3004.3
26	M6 VZ	9031.3903	9031.3903
27	M6 x 30	9030.0277	9030.0277
28	I ø67/40 x 1	9221.3300.4	9221.3300.4
29	A ø78/50 x 1	9221.3299.4	9221.3299.4
30	ø68/50 x 2	9031.3018	9031.3018
31	ø69 x 7.5	9221.3111.4	9221.3111.4
32	M6 VZ	9031.1276	9031.1276
33	EM 200/500	9235.3015.4	9235.3015.4
34	M6 x 25	0030.2124	0030.2124
35	M5	9058.5001	9058.5001
37	5.3/10 x 1 MS	0031.0616	0031.0616
38	M5 VZ	9031.3902	9031.3902
40	A 60 x 2	0031.1028	0031.1028
41	Rd 143 x 40	9230.3053.4	9235.3060.4
	Rd 152 x 41		9235.3060.4
41a	ø95 x 2.5	9035.0017	9035.0017
42	6012-2RS	0038.1085	0038.1085
43	10 x 13 x 31.43	9036.0603	9036.0603
44	Rd 97 x 137	9230.3050.2	9231.3050.2
	Rd 99.6 x 137		9231.3050.2
45	6014-2Z	0038.1066	0038.1066
46	J 110 x 4	0031.1137	0031.1137
47	1000/2000 kg	9221.3413.4	
	2000/4000 kg		9231.3198.4
48	329 x 237 x 5	9235.3003.2	9235.3003.2
49	M8 x 35 VZ	9030.0289	9030.0289

		EM 200 NL	EM 500 NL
50	M8 VZ	9031.3904	9031.3904
51	M8 x 30 VZ	9030.0288	9030.0288
52	EM 200/500	9230.3004.2	9230.3004.2
53	A 35 x 1.5	0031.1020	0031.1020
54	Rd 130 x 27	9230.3052.4	9235.3058.4
	Rd 130 x 28		9235.3058.4
55	6207	0038.1108	0038.1108
56	8 x 9 x 21.63	9036.0601	9036.0601
57	Rd 57.85 x 100	9230.3055.4	9235.3061.4
	Rd 52 x 100		9235.3061.4
58	NJ 205	0038.1824	0038.1824
59	332 x 295 x 190	9235.3000.0	9235.3062.4
	332 x 295 x 190		9235.3062.4
60	PG 11	9055.3006	9055.3006
61	M8/10 x 40	0030.4100	0030.4100
62	18/14 x 1.5 x 70	9215.3007.4	9215.3007.4
63	M5 x 12 VZ	0030.3468	0030.3468
64	EM 200/500	9230.3073.4	9230.3073.4
66	ø8/5.2 x 30	9038.2255	9038.2255
67	M5 x 40 VZ	0030.3474	0030.3474
68	M5 x 45 VZ	9030.0310	9030.0310
69	ø12/6 x 35	9235.3017.4	9235.3017.4
70		9230.3007.3	9231.3007.3
70a	M10 VZ	9031.3801	9031.3801
71	M10 x 90/32 VZ	9030.0301	9030.0301
72	64 x 52 x 11	9230.3010.4	9230.3010.4
73	9 x 27	9039.0010	9039.0011
	10 x 28		9039.0011
74	M8	0031.0008	0031.0008
75	BK 4020	0038.3263	0038.3263
76		9230.3059.4	9231.3059.4
77	M8 x 70 VZ	9030.0294	9030.0294
78	ø80/73 x 20	9230.3058.4	9230.3058.4
79	M5 x 8 DIN 916 VZ	9030.2750	9030.2750
80	ø10 x 40	9230.3065.4	9231.3065.4
81	ø55 M24 x 2	9230.3069.4	9230.3069.4
82	AS 3552	0038.3126	0038.3126
83	AXK 3552	9038.0253	9038.0253
84	ø5 x 50	0031.6048	0031.6048
85	120 x 50 x 50	9230.3068.3	9230.3068.3
86	M24 x 2	9031.1450	9031.1450
87	M6 x 10	0030.2322	0030.2322
88	M3 x 30 VZ	0030.3439	0030.3439
89	M3 x 25 VZ	0030.3438	0030.3438
90	M3 VZ	0031.0034	0031.0034
91	M3 VZ	9031.3900	9031.3900
92	8.5/1.5 x 30	9210.3065.4	9210.3065.4
93	ø6.8 x 21	9210.3345.4	9210.3345.4
94	8/0.75 x 12	9210.3067.4	9210.3067.4
95	M3 x 14 VZ	9030.3251	9030.3251
96	XG3	9051.0500	9051.0500
97	80 x 3 x 66	9210.3105.4	9210.3105.4
98		9210.3107.4	9210.3107.4

		EM 200 NL	EM 500 NL
99	12 x 60	9210.3100.4	9210.3100.4
100	15 x 15 x 30	9210.3108.4	9210.3108.4
101	ø10 x 119	9230.3072.4	9230.3072.4
102	M4 x 8 SW	9030.0001	9030.0001
103	6005-LLUA	9038.0005	9038.0005
104	2-F	9058.0018	9058.0018
105	4-F	9058.0017	9058.0017
106		9058.0019	9058.0019
107		9058.0020	9058.0020
108	1.6 A	9052.0010	9052.0010
109	ø5 x 36	0031.6045	0031.6045
110	1 t	9220.3474.4	9221.3412.4
	2 t		9231.3196.4
111	2.6 x 6	9031.6602	9031.6602
112	Gr. 6	9031.1152	9031.1152
113	6 x 40	9031.7007	9031.7007
114	M6 x 40 VZ	0030.3492	0030.3492
115	ø9/6.2 x 15.5	9235.3094.4	9235.3094.4
117	ø37 x 83, 320 µF	9059.0011	9059.0011
	ø42 x 83, 80 µF		9059.0013
118	ø55 x 120, 80 µF	9059.0012	9059.0012
119	50/8 x 100	9235.3091.4	9235.3091.4
120	M8 x 0.5d	0031.0188	0031.0188
121	M6 x 30 VZ	9030.0277	9030.0277
122	ø6.4/12.5 x 1.6	0031.0577	0031.0577
123	M5 x 12	9030.1806	9030.1806
124	4-F	9058.0024	9058.0024
125		9058.0022	9058.0022
200		9230.3096.3	9230.3096.3
201	8 x A / 7 x I 9 x A / 8 x I	9230.3232.4	9231.3199.4
202		9230.3008.1	9231.3014.1
203		9230.3009.3	9231.3015.3
204		9230.3070.3	9230.3070.3
205		9220.3482.4	9220.3482.4
206		9230.3071.4	9230.3071.4
207		9230.3077.4	9230.3077.4
208		9230.3233.4	9230.3233.4
209	110/220/42V 50/60Hz	9056.4506.4	9056.4506.4
210	110/220V 50/60Hz	9056.2504.4	9056.2504.4
211	Standard	9210.3667.4	9210.3667.4
212		9230.3079.4	9230.3079.4
213	L=80 -NL 1Ph 50Hz	9235.3090.3	9235.3090.3
	L=80 -NL 1Ph 60Hz	9235.3102.3	9235.3102.3
214	1Ph 42V	9222.2051.2	9222.2051.2
215	1Ph NA 42V	9222.2050.2	9222.2050.2